



ELL·ODI

LED LIGHT  
THERAPY MASK

EL00003

## CONTENTS

---

<b>Warnings for Use</b>	<b>5</b>
General Product Warnings	5
Symbols and Description	6
Contraindications	6
Adverse Reactions	6
Precautions	7
Special Exemptions	7
EMC – Declaration of conformity	7
<b>Warranty details</b>	<b>11</b>
60 Day Satisfaction Guarantee	11
<b>Intended Use &amp; Product Description</b>	<b>12</b>
Intended Use & Indications for Use	12
Product Description	12
<b>Product Specification</b>	<b>13</b>
<b>LED Light Therapy Overview</b>	<b>14</b>
How does LED Light Therapy work?	14
LED Light Therapy Treatments	14
<b>What to expect</b>	<b>14</b>
<b>Disclaimer</b>	<b>14</b>
<b>Parts List</b>	<b>15</b>
<b>Product overview</b>	<b>15</b>
<b>Using Your LED Light Mask</b>	<b>16</b>
Light Sensitivity Test	16
Treatment instructions	16
Power and Charging	17
<b>Maintenance</b>	<b>17</b>
Disposal	17
<b>Storage</b>	<b>17</b>
<b>Troubleshooting</b>	<b>17</b>
<b>One last thing</b>	<b>18</b>

## WARNINGS FOR USE

---









### General Product Warnings

1. This device is not for use over the eyes and is not for use on eyelids. Do not look into the light emitting diodes when using this device.
2. Do not attempt to operate this equipment if there is evidence showing that this product is damaged, or you suspect that this product is damaged because it may be harmful to your health. Ask for technical support if you find any damage to in the product.
3. Only authorized personnel may service this equipment, contact Ellodi Customer Service for servicing or repairing.
4. Do not lie or apply undue pressure to the LED Light Therapy Mask. The device cannot withstand a human weight or other extremely external pressure. Do not place the device under clothing, blankets, sheets, or towels.
5. When charging the battery controller, please disconnect the mask from the battery controller and connect the controller USB-C port to the adaptor first, then plug the adapter into to the power supply.
6. Please do not place the LED Light Therapy Mask where it may fall into water or other liquid. If the device falls into water or liquid, please unplug immediately.
7. Do not use the LED Light Therapy Mask while you are bathing or taking a shower.
8. Keep the device away from thermal energy.
9. Do not use the LED Light Therapy Mask if any part is damaged, including the cord or plug.
10. Do not attempt to disassemble the LED Light Therapy Mask.
11. The LED mask is not designed for use by children. Do not let unsupervised children use the LED Light Therapy Mask.
12. If the device overheats, turn it off immediately.
13. Keep the device away from flammable liquids and aerosol products or where it is filled with oxygen.
14. Please avoid using this product when it was stacked with other equipment or near the interfering equipment because it will be harmful to the product, and it could cause unexpected treatment results.
15. Use of accessories other than those specified or provided by the manufacturer of this equipment could result in increased electromagnetic emissions or decreased electromagnetic immunity.
16. This equipment has been tested for radiated RF immunity only at specified frequencies, when it uses near emitters at other frequencies could cause unexpected treatment results.
17. This device is not for use by persons under the age of 22.
18. Face filling plastic surgery (hyaluronic acid and other infusions) have been used within one month. It is not recommended to use this product.
19. If you have been sunburnt, please do not use for up to 2 weeks to allow your skin to repair.
20. Warning: The mask should not be used if directly connected to the USB wall charger, this will cause excessive voltage and current, damage the equipment, and damage the skin.
21. Warning: Do not use the LED mask while the battery controller is being charged.
22. Warning: There are two power ports on the mask, only connect the battery controller to one of them, and leave another port idle. Never connect the idle port with adaptor or another controller.
23. Only use adaptor provided by the manufacturer, Model No.: DZ012ELL050200S; Adaptor input: AC 100-240V~50/60Hz, output: 5V DC 2A 10W.
24. WARNING: A long USB cable can cause strangulation. Please keep it out of reach of children.
25. WARNING: Do not modify this equipment without authorization of the manufacturer.
26. WARNING: If the wall socket used to power the equipment has poor connections, the plug of the equipment becomes hot. Make sure you plug the equipment into a properly installed wall socket to avoid the risk of fire and burns.
27. WARNING: Do not leave the equipment unattended when it is switched on to avoid the risk of fire or burns.
28. WARNING: This equipment is not intended for use by persons with reduced physical, sensory or mental capabilities, or lack of experience and knowledge, unless they have been given supervision or instruction concerning use of the equipment to avoid the risk of fire or burns.
29. CAUTION: Do not subject the equipment to heavy shocks to avoid risk of damage to the lamp.
30. Do not expose the device to direct sunlight and protect them against dirt and moisture.

This device is internally power equipment with type BF applied part.

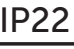
This device complies with Medical Electrical Safety Standards (IEC 60601-1, IEC 60601-1-11 and IEC 60601-2-57, IEC 60601-2-83 and Medical EMC standard (IEC 60601-1-2).

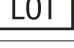
## Symbols and Description

Symbols	Description
	Manufacturer
	"WEEE (Waste Electrical and Electronic Equipment)". The waste products should be hand RGB legally.
	CONSULT INSTRUCTIONS FOR USE.
	The date of manufacture
	Protection against ingress of solids, it means the volume of the solids should less than 12mm. Protection against ingress of water, it means the device could protected against vertical falling water drop 15°.
	Type BF Applied Part
	Batch code
	Symbol for "SERIAL NUMBER". This symbol shall be accompanied by the manufacturer's serial number.

## Contraindications

*NOTE: Do not use if any of the following occur*

- Do not use this device if you are photosensitive.
- Do not use if the user is pregnant or breastfeeding.
- Do not use on infants or children.
- Avoid use if using photosensitive drugs.
- Do not use if you have a medical history of seizures that were triggered by light.
- Some light wavelengths may cause seizures.
- Please do not use the LED Light Therapy Mask over the part of the thyroid gland in the neck area, as it may stimulate thyroid gland's growth.
- Do not use if you have severe acne.
- Do not use the LED mask when you have skin problems such as lupus erythematosus, photosensitive eczema, albinism, or cancerous lesions as you may cause a severe skin reaction.
- Do not use if you have light induced headaches or migraines.

## Adverse Reactions

If you have any adverse reaction from using this device, stop using it immediately.

*NOTE: If you experience any discomfort, such as skin discolouration, skin damage, or any other concerns develop, stop using the device immediately and consult your doctor.*

## Precautions

- Stop using the LED Light Therapy Mask if you experience any adverse reactions. If you are concerned about the LED Light Therapy Mask, please consult a medical physician as you may be light sensitive.
- The intended use of the LED Light Therapy Mask is only as described in the manual.
- Do not look directly at the light source during the treatment.
- Do not use the LED Light Therapy Mask if you are sensitive to light.
- Do not use the LED Light Therapy Mask if you are taking drugs that are known to increase sensitivity to light.
- Do not use the LED Light Therapy Mask to take steroids or NSAIDs because you may result in a photosensitive reaction.
- Do not use the LED Light Therapy Mask if you have been received a steroid injection in the past 6 months, because you may result in a photosensitive reaction.
- Do not use the LED Light Therapy Mask at where other devices emit electromagnetic energy in an unshielded manner. Medical electrical equipment can be affected by the portable or mobile communication equipment with radio frequency.
- Do not scratch or damage the light-emitting surface in other negative ways.
- Do not use the light of this device to shine the eyes of others.
- It will void your warranty if you do not operate the LED Light Therapy Mask according to the manual's instructions.
- Read all instructions carefully before using this device.
- Inspect the LED Light Therapy Mask before use in case of damage.
- Store the LED Light Therapy Mask according to the suggestion listed in this manual.
- Do not share your LED mask with anyone else.

## Special Exemptions

This device should not be used by the following groups of people:

- Infants or children
- Pregnant or breastfeeding women
- Using photosensitive drugs
- Unable to express themselves

## EMC – Declaration of conformity

- **WARNING:** Using cell phone or microwave oven, HF surgical equipment, magnetic resonance imaging or other radio radiant equipment near this product may cause malfunction or lead to loss of essential performance.
- **WARNING:** Use of this equipment adjacent to or stacked with other equipment should be avoided because it could result in improper operation. If such use is necessary, this equipment and the other equipment should be observed to verify that they are operating normally.
- **WARNING:** Use of adapter or USB cable other than those specified or provided by the manufacturer of this equipment could result in increased electromagnetic emissions or decreased electromagnetic immunity of this equipment and result in improper operation.
- **WARNING:** Portable RF communications equipment (including peripherals such as antenna cables and external antennas) should be used no closer than 30 cm (12 inches) to any part of LED Light Therapy Mask, including cables specified by the manufacturer. Otherwise, degradation of the performance of this equipment could result.

The LED Light Therapy Mask is also compliant with Medical EMC Standard (IEC 60601-1-2).

Guidance and manufacture's declaration – electromagnetic emission		
The Ellodi LED Light Therapy Mask is intended for use in the electromagnetic environment specified below. The customer or the user of the Ellodi LED Light Therapy Mask should assure that it is used in such an environment.		
Emissions	Compliance	Electromagnetic environment – guidance
RF emissions CISPR 11	Group 1	The Ellodi LED Light Therapy Mask uses LED energy only for its internal function. Therefore, its RF emissions are very low and are not likely to cause any interference in nearby electronic equipment.
RF emissions CISPR 11	Class B	The Ellodi LED Light Therapy Mask is suitable for use in all establishments, including domestic establishments and those directly connected to the public low-voltage power supply network that supplies buildings used for domestic purposes.
Harmonic emissions IEC 61000-3-2	Not applicable	
Voltage fluctuations/flicker emissions IEC 61000-3-3	$P_{st} \leq 1.0$ ; $P_{st} \leq 0.65$ ; $d_{10} \text{ sec} \leq 0.5$ ; $d_{max} \leq 4\%$ ; $d_c \leq 3.3\%$	

Guidance and manufacture's declaration – electromagnetic immunity			
The Ellodi LED Light Therapy Mask is intended for use in the electromagnetic environment specified below. The customer or the user of the Ellodi LED Light Therapy Mask should assure that it is used in such an environment.			
Immunity test	IEC 60601 test level	Compliance level	Electromagnetic environment-guidance
Electrostatic discharge (ESD) IEC 61000-4-2	$\pm 8\text{kV}$ contact; $\pm 2\text{kV}$ , $\pm 4\text{kV}$ , $\pm 8\text{kV}$ , $\pm 15\text{kV}$ air	$\pm 8\text{kV}$ contact; $\pm 2\text{kV}$ , $\pm 4\text{kV}$ , $\pm 8\text{kV}$ , $\pm 15\text{kV}$ air	Floors should be wood, concrete or ceramic tile. If floors are covered with synthetic material, the relative humidity should be at least 30%.
Electrical fast transients/bursts IEC 61000-4-4	$\pm 2\text{ kV}$ 100 kHz repetition frequency	$\pm 2\text{ kV}$ 100 kHz repetition frequency	Mains power quality should be that of a HOME HEALTHCARE ENVIRONMENT
Surges IEC 61000-4-5	$\pm 0.5\text{ kV}$ , $\pm 1\text{ kV}$ Line-to-line	$\pm 0.5\text{ kV}$ , $\pm 1\text{ kV}$ Line-to-line	Mains power quality should be that of a HOME HEALTHCARE ENVIRONMENT
Voltage dips, short interruptions and voltage variations on power supply input lines IEC 61000-4-11	0 % UT; 0.5 cycle (At 0°, 45°, 90°, 135°, 180°, 225°, 270° and 315°) 0 % UT; 1 cycle and 70 % UT; 25/30 cycles (Single phase: at 0°) 0 % UT; 250/300 cycle	0 % UT; 0.5 cycle (At 0°, 45°, 90°, 135°, 180°, 225°, 270° and 315°) 0 % UT; 1 cycle and 70 % UT; 25/30 cycles (Single phase: at 0°) 0 % UT; 250/300 cycle	Mains power quality should be a HOME HEALTHCARE ENVIRONMENT. If the user of the Ellodi LED Light Therapy Mask requires continued operation during power mains interruptions, it is recommended that the Ellodi LED Light Therapy Mask be powered from an uninterruptible power supply or a battery.
Power frequency (50/60 Hz) magnetic field IEC 61000-4-8	30 A/m	30 A/m	Power frequency magnetic fields should be at levels characteristic of a HOME HEALTHCARE ENVIRONMENT



NOTE:  $U_1$  is the a.c. mains voltage prior to application of the test level

Guidance and manufacture's declaration – electromagnetic immunity			
LED Light Therapy Mask is intended for use in the electromagnetic environment specified below. The customer or the user of LED Light Therapy Mask should assure that it is used in such an environment.			
Immunity test	IEC 60601 test level	Compliance level	Electromagnetic environment - guidance
Radiated RF EM fields IEC 61000-4-3	10V/m 80MHz – 2.7GHz 80% AM at 1kHz	10V/m 80MHz – 2.7GHz 80% AM at 1kHz	Portable and mobile RF communications equipment should be used no closer to any part of the LED Light Therapy Mask, including cables, than the recommended separation distance calculated from the equation applicable to the frequency of the transmitter. Recommended separation distance: $d = [1.2] \sqrt{P}$ 80 MHz to 800 MHz $d = [2.3] \sqrt{P}$ 800 MHz to 2.7 GHz where P maximum output power rating of the transmitter in watts (W) according to transmitter manufacturer and D is the recommended separation distance in meters (m). Field strengths from fixed RF transmitters, as determined by an electromagnetic site survey, should be less than the compliance level in each frequency range. Interference may occur in the vicinity of equipment marked with the following symbol:
Conducted disturbances induced by RF fields IEC 61000-4-6	3Vrms in 0.15MHz – 80MHz; 6Vrms in ISM and amateur radio bands between 0.15MHz and 80MHz 80% AM at 1kHz	3Vrms in 0.15MHz – 80MHz; 6Vrms in ISM and amateur radio bands between 0.15MHz and 80MHz 80% AM at 1kHz	Recommended separation distance: $d = [1.2] \sqrt{P}$ 150 kHz to 80 MHz
Note: The ISM (industrial, scientific and medical) bands between 0,15 MHz and 80 MHz are 6,765 MHz to 6,795 MHz; 13,553 MHz to 13,567 MHz; 26,957 MHz to 27,283 MHz; and 40,66 MHz to 40,70 MHz. The amateur radio bands between 0,15 MHz and 80 MHz are 1,8 MHz to 2,0 MHz, 3,5 MHz to 4,0 MHz, 5,3 MHz to 5,4 MHz, 7 MHz to 7,3 MHz, 10,1 MHz to 10,15 MHz, 14 MHz to 14,2 MHz, 18,07 MHz to 18,17 MHz, 21,0 MHz to 21,4 MHz, 24,89 MHz to 24,99 MHz, 28,0 MHz to 29,7 MHz and 50,0 MHz to 54,0 MHz.			
Note 1: At 80 MHz and 800 MHz, the higher frequency range applies.			
Note 2: These guidelines may not apply in all situations. Electromagnetic propagation is affected by absorption and reflection from structures, objects and people.			
a: The field strengths from fixed transmitters, such as base stations for radio (cellular/cordless) telephones and land mobile radios, amateur radio, AM and FM radio broadcast and TV broadcast cannot be predicted theoretically with battery. To determine to electromagnetic environment resulting from the fixed RF transmitters, an electromagnetic site survey should be considered. Where the measured field strength in the location in which the LED Light Therapy Mask is used exceeds the applicable RF compliance level indicated above, the LED Light Therapy Mask should be observed to verify the normal operation. Where abnormal power is observed, additional measures may be necessary, such as reorienting or relocating the LED Light Therapy Mask.			
b: Over the frequency range 150 kHz to 80 MHz, the field strengths should be less than 3V/m.			

Guidance and manufacture's declaration – electromagnetic immunity			
LED Light Therapy Mask is intended for use in the electromagnetic environment specified below. The customer or the user of LED Light Therapy Mask should assure that it is used in such an environment.			
Immunity test	IEC 60601-1-2 test level	Compliance level	Electromagnetic environment - guidance
Proximity fields from RF wireless communications equipment IEC 61000-4-3	See the following table	Complies	

Test frequency (MHz)	Band (MHz)	Service	Modulation	Maximum power (W)	Distance (m)	Immunity Test Level (V/m)
385	380 – 390	TETRA 400	Pulse modulation 18 Hz	1.8	0.3	27
450	430 – 470	GMRS 460, FRS 460	FM ± 5 kHz deviation 1 kHz sine	2	0.3	28
710	704 – 787	LTE 13, 17 Band	Pulse modulation 217 Hz	0.2	0.3	9
745						
780						
810	800 – 960	GSM 800/900, TETRA 800, iDEN 820, CDMA 850, LTE Band 5	Pulse modulation 18 Hz	2	0.3	28
870						
930						
1720	1700 – 1990	GSM 1800; CDMA 1900; GSM 1900; DECT; LTE 1, 3, 4, 25 band; UMTS	Pulse modulation 217 Hz	2	0.3	28
1845						
1970						
2 450	2400 – 2570	Bluetooth, WLAN, 802.11 b/g/n, RFID 2450, LTE 7 band	Pulse modulation 217 Hz	2	0.3	28
5 240	5100 – 5800	WLAN 802.11 a/n	Pulse modulation 217 Hz	0.2	0.3	9
5 500						
5 785						
NOTE If necessary to achieve the IMMUNITY TEST LEVEL, the distance between the transmitting antenna and the ME EQUIPMENT or ME SYSTEM may be reduced to 1 m. The 1 m test distance is permitted by IEC 61000-4-3.						
a) For some services, only the uplink frequencies are included. b) The carrier shall be modulated using a 50 % duty cycle square wave signal. c) As an alternative to FM modulation, 50 % pulse modulation at 18 Hz may be used because while it does not represent actual modulation, it would be worst case.						

Recommended Separation Distance between Portable and Mobile RF Telecommunications Equipment and LED Light Therapy Mask.			
LED Light Therapy Mask is intended for use in an electromagnetic environment in which radiated RF are controlled. The customer or the user of LED Light Therapy Mask can help prevent electromagnetic interferences by maintaining a minimum distance between portable and mobile RF communications equipment (transmitters) and the endoscope as indicated below – according to the maximum output power of the communication equipment.			
Maximum output power rating of the transmitter W	Separation distance according to frequency of transmitter in meter [m]		
	150kHz ~ 80MHz d=1.2√(p)	80MHz ~ 800MHz d=1.2√(p)	800MHz ~ 2.5GHz d=2.3√(p)
.01	0.12	0.12	0.23
.1	0.38	0.38	0.73
1	1.2	1.2	2.3
10	3.8	3.8	7.3
100	12	12	23
For transmitters with a maximum output power rating not listed above, the recommended separation distance d in meters (m) can be determined by using the equation applicable to the frequency of the transmitter where P is the maximum output power rating of the transmitter in watts (W) according to transmitter manufacturer list. Note 1: At 80 MHz and 800 MHz, the higher frequency range applies. Note 2: These guidelines may not apply in all situations. Electromagnetic propagation is affected by absorption and reflection from structures, objects and people.			

## WARRANTY DETAILS

Our goods come with guarantees that cannot be excluded under the Australian Consumer Law. You are entitled to a replacement or refund for a major failure and compensation for any other reasonably foreseeable loss or damage. You are also entitled to have the goods repaired or replaced if the goods fail to be of acceptable quality and the failure does not amount to a major failure.

If you experience any issues with this product, or its performance is not what you had expected please contact us at Ellodi.

- Describe your problem with the product to our Customer Service Team
- If we need the product returned, our team will provide shipping details
- Once the returned product is received, our team will offer a replacement, credit or refund depending on the product problem

### 60 Day Satisfaction Guarantee

If you are not satisfied with our product or change your mind, simply contact our Customer Service Team within 60 days of receiving your product to initiate a return. Shipping fees will apply.

**Email:** help@ellodi.com.au

**Phone:** 1300 173 989 (Mon-Fri 8.30am-6.00pm EST)

**Web:** www.ellodi.com.au

## INTENDED USE & PRODUCT DESCRIPTION

### Intended Use & Indications for Use

The LED Light Therapy Mask (Model: EL00003) is an over the counter device, intended to emit energy in the red and blue region of the light spectrum, specifically indicated to treat mild to moderate acne vulgaris of the face.

The LED Light Therapy Mask (Model: EL00003) is an over the counter device, intended to emit energy in the red and Near Infra-red spectrum and is intended for the use in the treatment of full-face wrinkles.

### Product Description

The LED Light Therapy Mask is a home wearable light-emitting diode phototherapy device whose purpose is to produce an even, cool, narrow band of light for the treatment of full-face wrinkles, or mild to moderate acne vulgaris of the face.

The device is not used to make measurements of any sort, or to draw any conclusions regarding the indication to treat. The device does not require checks on the light output as the LEDs do not dim with age to any practical extent.

Model EL00003 produce blue, red, and near infra-red (NIR) light in the visible spectrum (Blue: 415nm, Red: 630+/- 5nm, NIR: 830nm). The device works by emitting the specified wavelengths into the skin in order to improve the appearance of wrinkles or to target bacteria that can cause acne vulgaris. The controller switches the LEDs ON/OFF, controls power to the mask, and switches treatment modes. The cable for connecting with the controller is detachable. EL00003 have two pieces of removable eye protection which are for protect eyes from the light.

## PRODUCT SPECIFICATION

Product name	LED Light Therapy Mask
Model	EL00003
Power source	3.7Vdc 2600mAh Lithium battery
Weight	289g (face mask and controller)
Dimensions	461.33mm x 220.97mm (W x L)
Wavelengths	415nm, 630±5nm, 830nm
Energy Source	66 LEDs
Total Power Density	Blue/Red 44mw/cm <sup>2</sup> , Re/NIR 30mw/cm <sup>2</sup>
Treatment time	Acne: 4 x weekly , 6 weeks; Wrinkles: 5 x weekly , 6 weeks
Location for Use	Face
Environment of Use	OTC
Safety and EMC Standards	IEC 60601-1, IEC 60601-1-2, IEC 60601-1-11, IEC 60601-2-57
Biocompatibility Standards	ISO 10993-1, ISO 10993-5, ISO 10993-10
Operating Environment	Temperature: -10 - 35 C Humidity: 30-80% RH Atmospheric pressure: 700-1060hPa
Storage or Transport Environment	Temperature: -20 - 60 C Humidity: 30-90% RH Atmospheric pressure: 700-1060hPa
Expected Service Life	2 years

## LED LIGHT THERAPY OVERVIEW

ElloDi's LED Light Therapy Mask is a flexible wearable LED mask that provides a non-invasive treatment designed to promote skin rejuvenation, reduce the appearance of wrinkles and acne, while minimising the visibility of pigmented areas, spots and marks.

Lightweight, flexible design with a rechargeable battery means you can either relax in comfort while you take in your treatment or wear on the go while you get tasks completed in the comfort of your own home.

### How does LED Light Therapy work?

Young skin is rich in collagen, collagen is a protein that holds the body and skin together and provides elasticity. Over time your body produces less collagen, it can also become damaged with sun exposure which will result in fine lines and wrinkles.

LED Light therapy uses light at specific wavelengths to penetrate the epidermis of the skin, the range of light increases collagen production resulting skin rejuvenation that will minimise fine lines and wrinkles.

### LED Light Therapy Treatments

The LED Light Therapy Mask has 2 treatment options :

#### 1 Anti-Ageing: Red & Infra-Red Light

- Red 630nm+ Infrared 830nm
- Helps to increase the production of collagen
- Helps to reduce fine lines and wrinkles
- Helps to minimise the appearance of sunspots, age spots
- Helps to enhance the appearance of skin tone

#### 2 Anti-Acne: Red & Blue Light

- Red 630nm+ Blue 415nm
- Helps to reduce blemishes and the appearance of acne
- Helps to calm redness caused by blemishes
- Helps to enhance the appearance of skin tone

## WHAT TO EXPECT

When in use you may feel a warm sensation on the skin, with the feeling of plumping of the skin from the first treatment

**After 1 week of treatments:** Some users will notice an improvement of the skins texture, with skin appearing more smooth and healthy

**After 2 weeks of treatments:** Most users will see an overall better condition of the skin, compared to their skin before starting treatment

**After 4 weeks of treatments:** Majority of users will notice improvements of the skin including a reduction in fine lines and wrinkles, reduced acne and overall more healthier looking skin compared to their skin before starting treatment

## DISCLAIMER

The results achieved by the use of this LED Light Therapy Mask are general and cosmetic, actual results will be dependent on other life choices and factors. Smoking, alcohol consumption, low hydration, sun exposure, diet and exercise are all factors that impact your skin and will impact the effectiveness of this product.

This product is not designed to cure or prevent any issue or disease. If you have skin concerns you should always consult a medical professional.

## PARTS LIST

- |                            |      |
|----------------------------|------|
| • LED Light Therapy Mask   | 1pc  |
| • Adjustable Velcro Straps | 2pcs |
| • Removable Eye Protection | 2pcs |
| • USB-C cable              | 1pc  |
| • Controller               | 1pc  |
| • Adapter                  | 1pc  |
| • User Manual              | 1pc  |
| • Storage bag              | 1pc  |

## PRODUCT OVERVIEW

1. LEDs
2. USB-C inputs
3. USB-A port
4. Power button
5. Mode indicators
6. Battery indicator
7. USB-C port

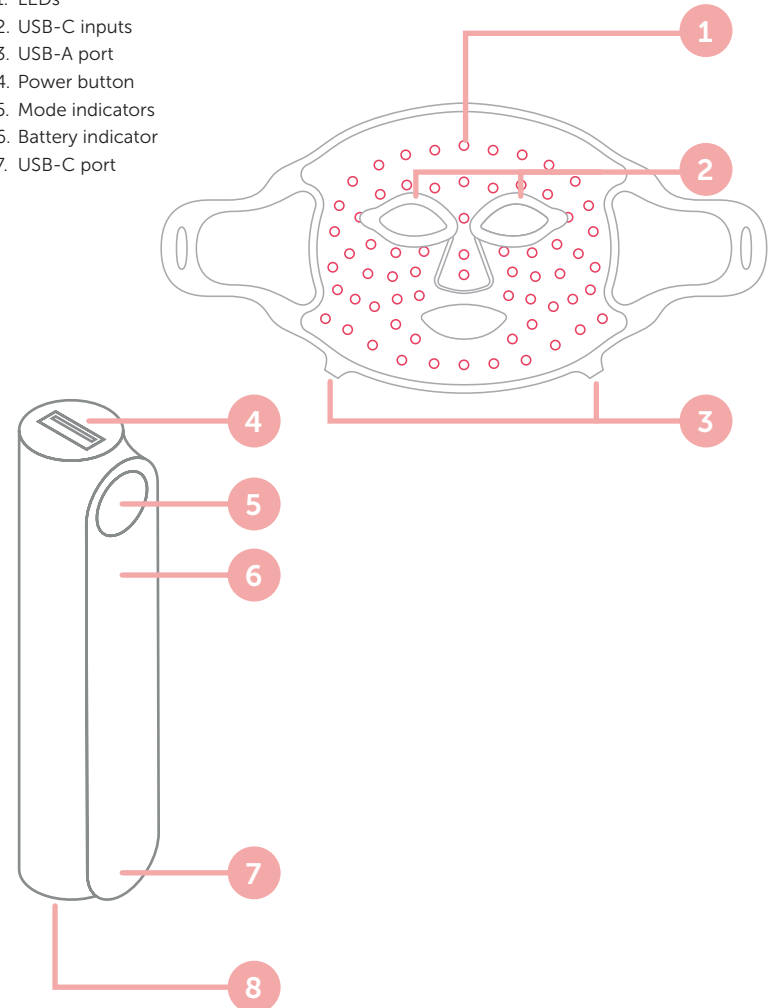



## USING YOUR LED LIGHT MASK

---

### Light Sensitivity Test

Before first treatment please check that you are not light sensitive. Use as per instructions below, however for 5 minutes only.

Wait for 24 hours, if over this time you experience any pain, discomfort or redness that lasts for more than 2 hours you maybe light sensitive. Please consult a doctor for advice.

### Treatment instructions

- 1 Before any treatment, always clean your skin of any moisturisers, sunscreens, or cosmetics
- 2 Attach the battery controller to the mask via USB-C power cable

#### WARNING:

- The mask should not be used if directly connected to the USB wall charger, this will cause excessive voltage and current that may damage the equipment, and damage your skin
- Do not use the LED mask while the battery controller is being charged.
- There are two power ports on the mask, only connect the battery controller to one of them, and leave another port idle. Never connect the idle port with adaptor or another controller

**NOTE:** You can use either outlet (left or right side) but only 1 outlet at a time

- 3 Attach the adjustable straps to the mask by threading through the sides of the mask
- 4 Install the removable eye protection to the mask
- 5 Apply the mask to your face, with the lights next to your skin, and strap around your head using the adjustable strap. Adjust the mask until you are comfortable, and your eyes and mouth are clear of the mask
- 6 Turn on the mask by pressing and holding the power button on the controller for 2 seconds
- 7 Quick press the button to cycle through the treatments an LED light will show above the treatment
  - Anti-Aging - Red 630nm+ Infrared 830nm
  - Anti-Acne - Red 630nm+ Blue 415nm
- 8 Hold and press the power button any time to stop the treatment
- 9 The mask treatment will last for 10 minutes, which is the recommended treatment time. To protect your skin do not use for longer than 10 minutes at any one time

**NOTE:** If you change treatments while in use the 10-minute treatment time will restart at 10 minutes. It is not recommended to use for longer than 10 minutes.

- 10 Once the treatment as finished the mask will turn off, wipe the mask with damp cloth and lay flat in the storage bag in preparation for next use
- 11 After treatment apply hydrating serums or moisturisers to replenish the moisture in your skin

### Power and Charging

- 1 Disconnect the mask from the battery controller
- 2 Connect the USB wall charger to the USB-C inlet at the bottom of the battery controller
- 3 Plug the USB wall charger into an outlet and switch on
- 4 The orange LED indicator light will stay solid while charging
- 5 When fully charged the LED indicator light will stay solid green

#### Battery Indicators

- **Power On:** Green
- **Power Low:** Orange flashing
- **Charging:** Orange
- **Treatment:** White line above treatment type

## MAINTENANCE

---

The mask should be cleaned after each use

- 1 Turn off the device and disconnect all cables prior to cleaning
- 2 Slightly dampen a cloth with water and wipe over the mask, avoid wiping electrical outlets
- 3 Allow the mask to dry in the air
- 4 Lie flat when not in use

#### WARNING:

- Do not use any abrasive cleaning agents
- Do not immerse in water or use a very wet cloth when cleaning
- Do not dismantle the housing
- If the cord or electrical outlets are damaged contact our customer service team for advice

#### Disposal

Dispose of the end-of-life product according to all applicable hospital, national and local laws and guidelines.

## STORAGE

---

- Always lie the face mask flat when not in use to prolong the life of the LED lights
- Keep in the storage box or a similar flat, clean and dry surface
- Do not bend or pull on the cord or connecting outlets to ensure longevity

## TROUBLESHOOTING

---

Problem	Solution
The battery controller does not turn on	Ensure that the controller of the mask has been fully charged
The LED Light Mask turns off while in use	The mask will turn off after a 10-minute treatment time. If it turns off prior to 10 minutes check that the battery controller is charged
The LED Light Mask lights flicker	Check all connections are secure and plugs are inserted correctly, and that the battery controller is charged

## ONE LAST THING

---

Thank you for your purchase!

We appreciate your support and hope you enjoy your new product, as a reminder if you do have any questions or are unhappy with any aspect of your purchase, please don't hesitate to reach out to our Customer Service Team who are here to help.

**Email:** [help@ellodi.com.au](mailto:help@ellodi.com.au)

**Phone:** 1300 173 989 (Mon-Fri 8.30am-6.00pm EST)

**Web:** [www.ellodi.com.au](http://www.ellodi.com.au)

And make sure you follow us on our social accounts to keep up to date with specials and new products.

Thanks,

The Team at Ellodi



Australian Sponsor: Balco Brands Pty Ltd

Address: PO Box 537 Bayswater Business Centre VIC 3153

[hello@ellodi.com.au](mailto:hello@ellodi.com.au)

1300 173 989



Shenzhen Kaiyan Medical Equipment Co., Ltd.

Building #3 and Building #5 40th of Fuxin Street, Huaide Community

Fuyong Town, Baoan District Shenzhen Guangdong 518103 China